

Exploded View - CAC4813HA15

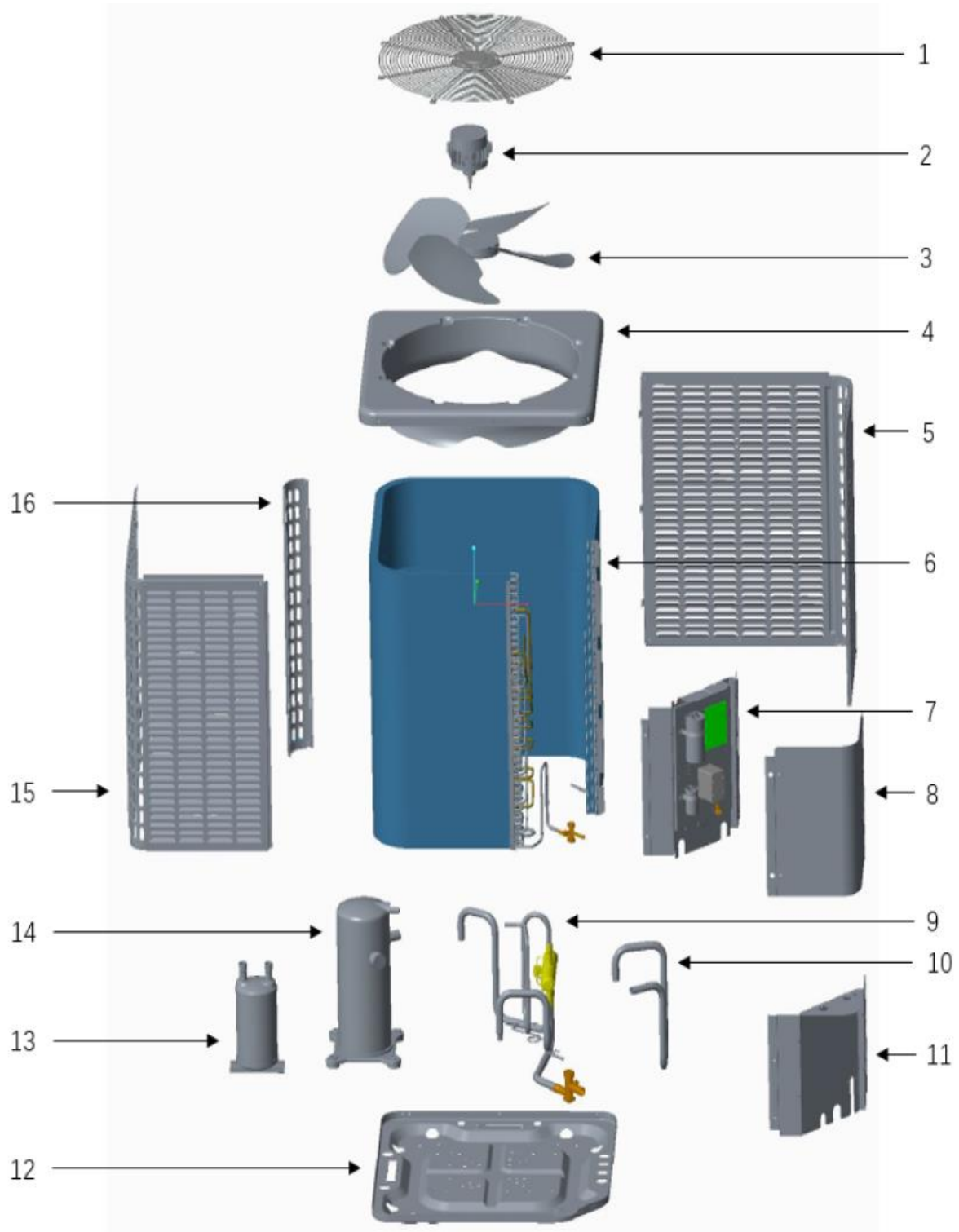

Exploded View - CAC4813HA15

| No. | Part No. | Part Name | Qty | Remark |
|-----|----------|-----------------------------------|-----|--------|
| 1 | 91037800 | Top air outlet grille | 1 | |
| 2 | 91043433 | Fan motor | 1 | |
| 3 | 91038105 | Axial-flow fan | 1 | |
| 4 | 91043102 | Top cover | 1 | |
| 5 | 91043115 | Right side panel | 1 | |
| 6 | 91044604 | Condenser assembly | 1 | |
| 6.1 | 91044297 | Condenser component | 1 | |
| 6.2 | 91043163 | Shunt components | 1 | |
| 6.3 | 91043164 | Gas collector assembly | 1 | |
| 6.4 | 91045653 | High pressure valve assembly | 1 | |
| 7 | 91044618 | Electronic control part | 1 | |
| 7.1 | 91043105 | Electronic control mounting plate | 1 | |
| 7.2 | 91043106 | PCB mounting base | 1 | |
| 7.3 | 91034034 | PCB | 1 | |
| 7.4 | 91041306 | AC contactor | 1 | |
| 7.5 | 91031803 | Compressor capacitor | 1 | |
| 7.6 | 91031792 | Fan capacitor | 1 | |
| 7.7 | 91043061 | Brass binding post | 1 | |
| 7.8 | 91041298 | Ambient temperature sensor | 1 | |
| 8 | 91043104 | Upper side panel | 1 | |
| 9 | 91045052 | 4-way valve assembly | 1 | |
| 10 | 91045054 | Gas return pipe assembly | 1 | |
| 11 | 91043107 | Lower side panel | 1 | |
| 12 | 91043101 | Base pan components | 1 | |
| 13 | 91042779 | Compressor | 1 | |
| 14 | 91037745 | Gas-liquid separator | 1 | |
| 15 | 91043114 | Left side panel | 1 | |
| 16 | 91043116 | Support plate | 1 | |
| 17 | 91040125 | Crankshaft heating belt | 1 | |
| 18 | 91041297 | Condenser temperature sensor | 1 | |
| 19 | 91041299 | Discharge temperature sensor | 1 | |
| 20 | 91045862 | 4-way valve coil | 1 | |