

Exploded View - CAC4813HA15

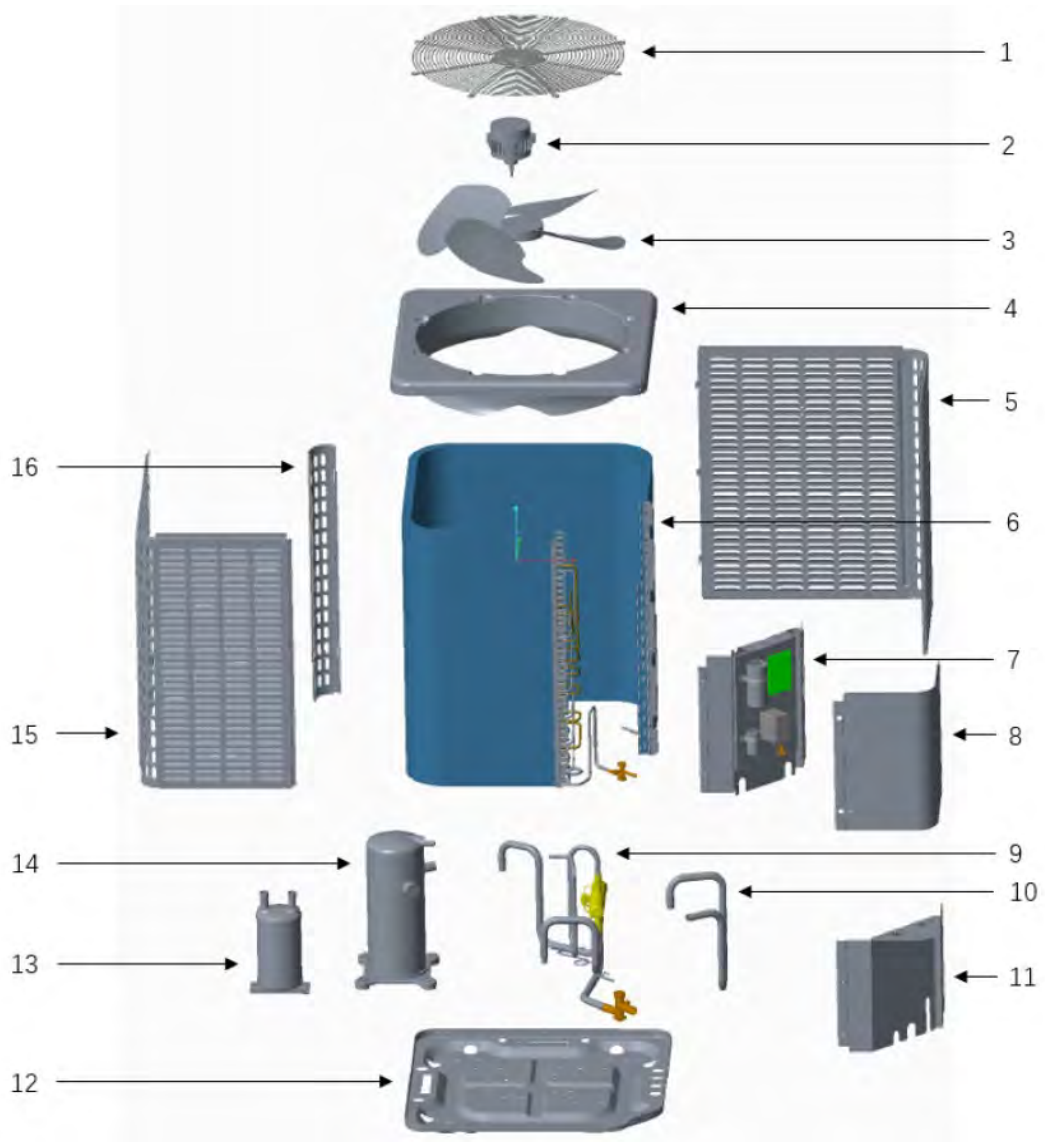

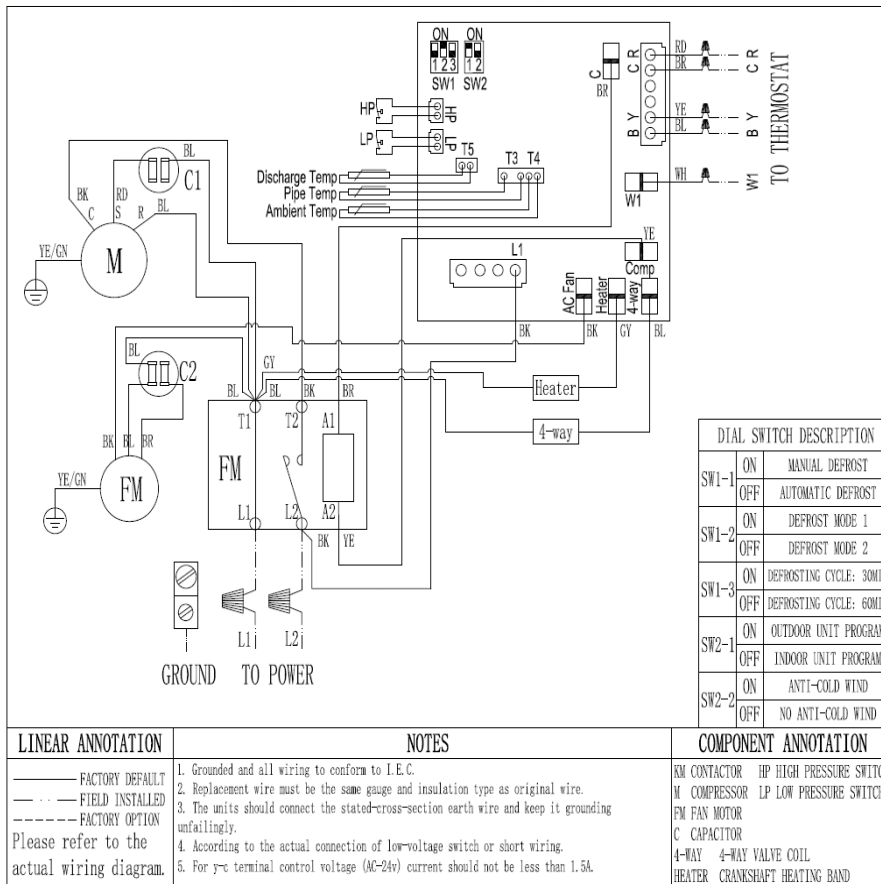

LINEAR ANNOTATION	NOTES	COMPONENT ANNOTATION
<p>————— FACTORY DEFAULT</p> <p>----- FIELD INSTALLED</p> <p>----- FACTORY OPTION</p> <p>Please refer to the actual wiring diagram.</p>	<p>1. Grounded and all wiring to conform to I.E.C.</p> <p>2. Replacement wire must be the same gauge and insulation type as original wire.</p> <p>3. The units should connect the stated-cross-section earth wire and keep it grounding unfaillingly.</p> <p>4. According to the actual connection of low-voltage switch or short wiring.</p> <p>5. For γ-c terminal control voltage (AC-24v) current should not be less than 1.5A.</p>	<p>FM CONTACTOR HP HIGH PRESSURE SWITCH</p> <p>M COMPRESSOR LP LOW PRESSURE SWITCH</p> <p>FM FAN MOTOR</p> <p>C CAPACITOR</p> <p>4-WAY 4-WAY VALVE COIL</p> <p>HEATER CRANKSHAFT HEATING BAND</p>

No.	Part Name	Quantity	Price(\$)	BOM Code	Remark
1	Top air outlet grille	1		91037800	17.22
2	Fan motor	1		91043433	48.59
3	Axial-flow fan	1		91038105	21.61
4	Top cover	1		91043102	29.75
5	Right side panel	1		91043115	26.53
6	Condenser assembly	1		91044604	441.95
6.1	Condenser component	1		91044297	383.89
6.2	Shunt components	1		91043163	21.05
6.3	Gas collector assembly	1		91043164	20.48
6.4	High pressure valve assembly	1		91045653	18.42
7	Electronic control part	1		91044618	55.38
7.1	Electronic control mounting plate	1		91043105	7.30
7.2	PCB mounting base	1		91043106	2.18
7.3	PCB	1		91034034	21.54
7.4	AC contactor	1		91041306	14.51
7.5	Compressor capacitor	1		91031803	5.78
7.6	Fan capacitor	1		91031792	2.38
7.7	Brass binding post	1		91043061	1.16
7.8	Ambient temperature sensor	1		91041298	0.48
8	Upper side panel	1		91043104	6.82
9	4-way valve assembly	1		91045052	44.16
10	Gas return pipe assembly	1		91045054	10.37
11	Lower side panel	1		91043107	6.72
12	Base pan components	1		91043101	30.36
13	Compressor	1		91042779	526.05
14	Gas-liquid separator	1		91037745	27.47
15	Left side panel	1		91043114	26.53
16	Support plate	1		91043116	3.89
17	Crankshaft heating belt	1		91040125	4.40
18	Condenser temperature sensor	1		91041297	0.74
19	Discharge temperature sensor	1		91041299	0.94
20	4-way valve coil	1		91045862	3.17