

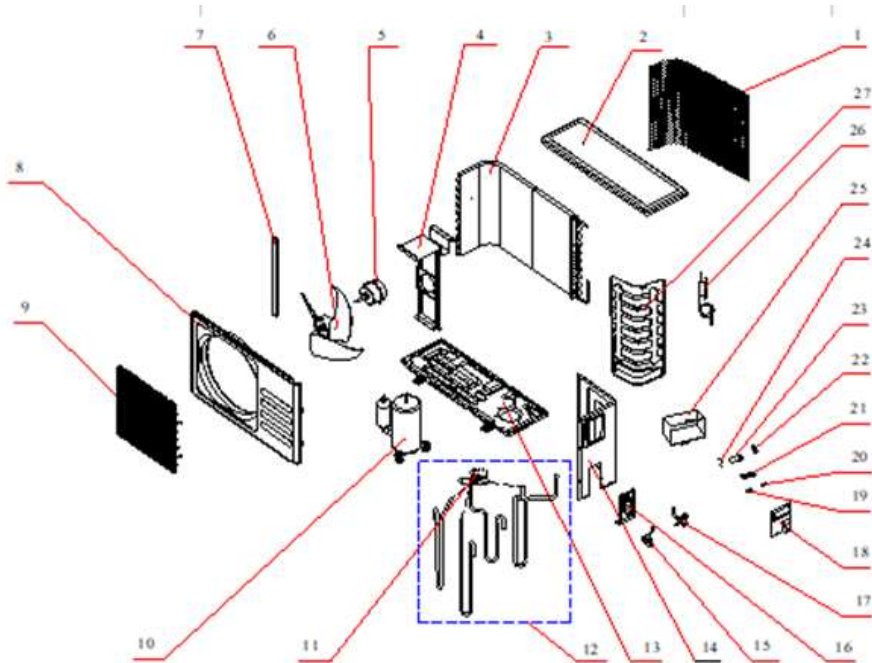

## Exploded View MRTH123C



| No. | Part No.     | Part Name               | Qty | Remark   |
|-----|--------------|-------------------------|-----|----------|
| 1   | 42011-000184 | Grille                  | 1   | Optional |
| 2   | 41207-000029 | Top Cover               | 1   |          |
| 3   | 92011-000559 | Condenser               | 1   |          |
| 4   | 41203-000054 | Outdoor Motor Supporter | 1   |          |
| 5   | 22001-000093 | Outdoor Motor           | 1   |          |
| 6   | 42004-000107 | Propeller Fan           | 1   |          |
| 7   | 41205-000121 | Left Grille Supporter   | 1   |          |
| 8   | 41206-000054 | Front Plate             | 1   |          |
| 9   | 42011-000088 | Fan Guard               | 1   |          |
| 10  | 92014-000223 | Compressor              | 1   |          |
| 11  | 92008-000177 | 4-way Valve             | 1   |          |
| 12  | 92007-000893 | 4-way Valve Assembly    | 1   |          |
| 13  | 41202-000177 | Base                    | 1   |          |
| 14  | 41205-000079 | Right Plate             | 1   |          |
| 15  | 92007-001037 | Two-way Valve           | 1   |          |
| 16  | 41204-000018 | Valve Supporter         | 1   |          |
| 17  | 92007-001041 | Three-way Valve         | 1   |          |
| 18  | 41201-000029 | Electrical Box Cover    | 1   |          |
| 19  | 42001-000037 | Cable Clamp(φ6)         | 1   |          |
| 20  | 42001-000035 | Cable Clamp(φ7)         | 1   |          |
| 21  | 11304-100007 | Terminal                | 1   |          |
| 22  | 10303-100019 | Fan Motor Capacitor     | 1   |          |
| 23  | 22003-000009 | Compressor Capacitor    | 1   |          |



## Exploded View MRTH1223C

| No. | Part No.     | Part Name            | Qty | Remark                          |
|-----|--------------|----------------------|-----|---------------------------------|
| 24  | 42001-000030 | Capacitor Strip      | 1   |                                 |
| 25  | 41214-000194 | Electrical Parts Box | 1   |                                 |
| 26  | 92007-001718 | Capillary Assembly   | 1   |                                 |
| 27  | 41208-000139 | Partition plate      | 1   |                                 |
| 28  | A1201-003463 | Cabinet Carton       | 1   | Not shown in the Exploded view. |
| 30  | A2005-000523 | Base Carton          | 1   |                                 |
| 32  | 41213-000023 | Cover Forming        | 1   |                                 |
| 34  | A1202-000031 | Base Forming         | 1   |                                 |