

## Exploded View METH1823C-16

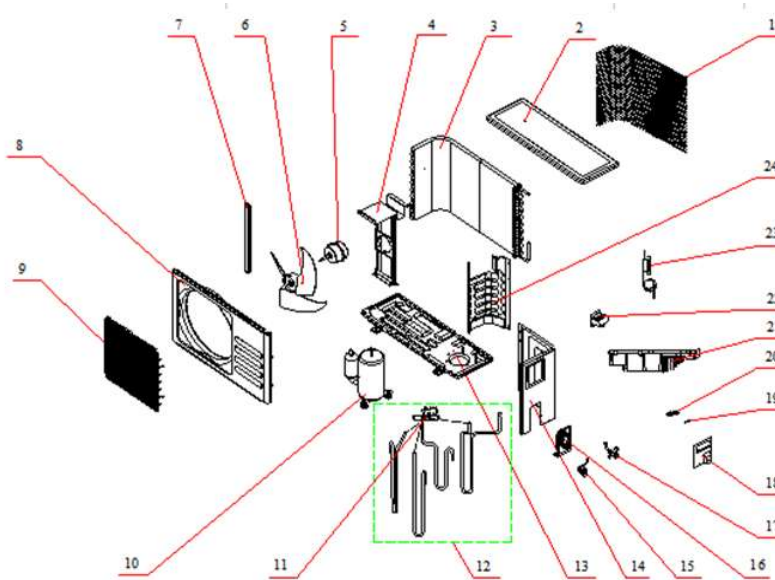

No.	Part No.	Part Name	Qty	Remark
1	42011-000159	Grille	1	
2	41207-000015	Top cover	1	
3	92011-000034	Condenser	1	
4	41203-000037	Outdoor motor supporter	1	
5	22001-000080	Outdoor motor	1	
6	42004-000073	Propeller fan	1	
7	41205-000124	Left grille supporter	1	
8	41206-000027	Front plate	1	
9	42011-000029	Fan guard	1	
10	92014-000318	Compressor and accessories	1	
11	92008-000209	4-way valve	1	
12	92007-000852	4-way valve assembly	1	
13	41202-000166	Base	1	
14	41205-000054	Right plate	1	
15	92008-000018	Two-way valve	1	
16	41204-000067	Valve supporter	1	
17	92008-000112	Three-way valve	1	
18	41201-000005	Electronic Box Cover	1	
19	42001-000038	Cable clamp1	1	
	42001-000035	Cable clamp2	1	
20	11304-100004	Terminal	1	
21	31201-000816	Outdoor PCB assembly	1	
22	22011-000004	Inductor	1	
23	92007-001966	Capillary Assembly	1	
24	41208-000146	Partition plate	1	
25	10104-100033	Pipe Temp. sensor and outdoor Temp. sensor	1	Not shown in explosion view



## Exploded View METH1823C-16

No.	Part No.	Part Name	Qty	Remark
26	10104-100015	Discharge Temp. sensor	1	Not shown in explosion view
27	A2005-000519	Base carton	1	
28	A1201-002588	Cabinet carton	1	
29	A1202-000007	Base foaming	1	
30	41213-000002	Cover foaming	1	