

Exploded View - MGC1823E-19

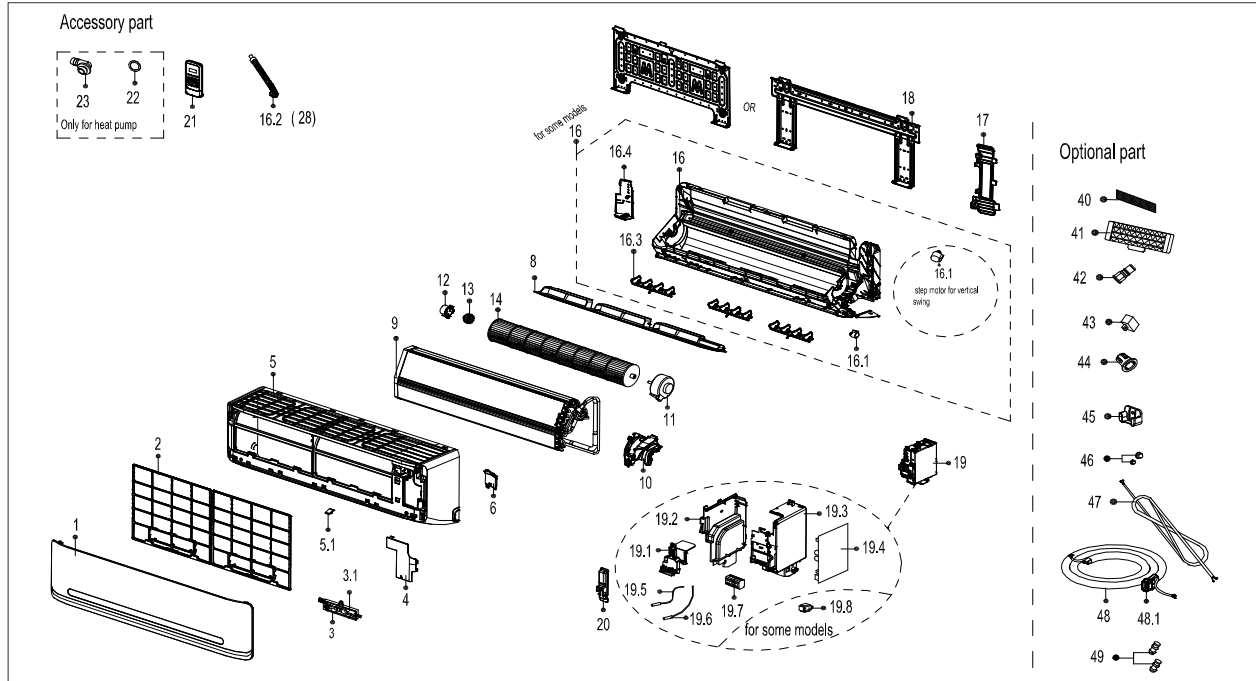

No.	Part No.	Part Name	Qty	Remark
1	12122000001083	Panel assembly	1.0	CE-KFR53G/N1Y-AB3.1(SY)
2	12100204000397	Air filter	2.0	
3	17222000002837	Display box subassembly	1.0	
3.1	17122000006953	Display board subassembly	1.0	EU-KFR26G/N1Y-AB3.ZD.JGN.WXXS.XS2.1
4	12122000006755	Cover of electrical equipment	1.0	
5	12122000002008	Panel frame assembly	1.0	
5.1	12122000008242	Screw Cap	1.0	
6	12122000004592	Front cover of chassis	1.0	
8	12122000006359	Horizontal louver	1.0	
9	15822000008214	Evaporator assembly	1.0	
10	12122000005538	Fan motor cover	1.0	
11	11002015000139	Brushless DC Motor	1.0	ZKFP-30-8-3
12	12122000000350	Bearing holder	1.0	
13	12622000000006	Bearing base	1.0	
14	12100102000131	Cross flow fan	1.0	GL-98*758-I
16	12122000A26278	Chassis assembly	1.0	
16.1	11002010000077	Stepper motor	1.0	SM-30-17-12-15
16.3	12122000008961	Horizontal louver	3.0	
16.4	12122000004612	Front cover of chassis(left)	1.0	
17	12122000012941	pipe clamp board	1.0	
18	12222000000026	Installation plate	1.0	



Exploded View - MGC1823E-19

No.	Part No.	Part Name	Qty	Remark
19	17222000021228	Electronic control box subassembly (Mid-and low-end)	1.0	
19.1	12122000004577	Electronic control box	1.0	
19.2	12122000004639	Left cover of electronic control box	1.0	
19.3	12122000004632	Right cover of electronic control box	1.0	
19.4	17122000034048	Main control board subassembly	1.0	US1-KF51G/BP3N1Y-ABC(Q0)- W.ZJD.JGN.WXNK.NK2.1
19.5	11201007003425	Room temperature sensor	1.0	CGQ-WD/SW4100-L500- XHBCP2BL-P450-HT1.0
19.6	11201007003447	Pipe Temperature Sensor	1.0	CGQ-WD/GW4100-L350- XACP2-P250
19.7	17400401000006	Terminal	1.0	JXZ-AD5Z(UL)-C(YF2004C)
20	12122000005020	Cover of electronic control box	1.0	
21	17317000001294	Remote controller	1.0	RG51F/EU1
28	12100501000032	Drain hose	1.0	
40	12100204000685	Air freshening filter	1.0	
46	15500406000016	Copper nut	1.0	TLM-A01
46	15500406000012	Copper nut	1.0	TLM-C03