

Exploded View MGTC3623C-17

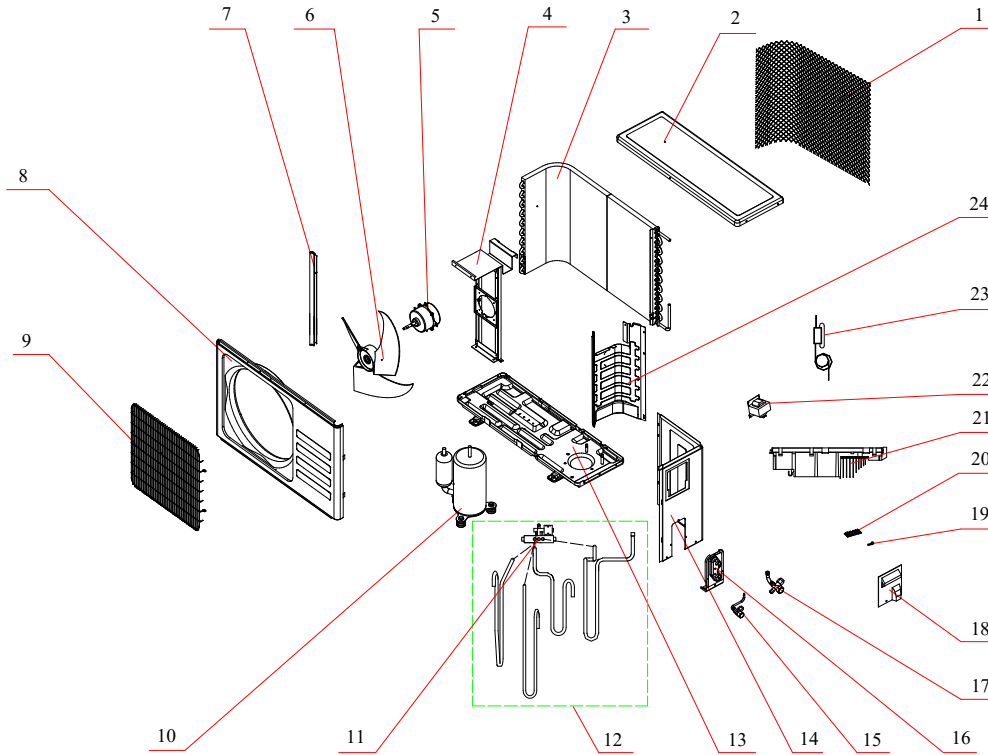

No.	Part No.	Part Name	Qty	Remark
1	42011-000166	Back Grille	1	Optional
2	41207-000016	Top cover	1	
3	92011-004586	Condenser	1	
4	41203-000030	Outdoor motor supporter	1	
5	22001-000120	Outdoor motor	1	
6	42004-000091	Propeller fan	1	
7	41205-000125	Left grille supporter	1	
8	41206-000046	Front plate	1	
9	42011-000031	Fan guard	1	
10	92014-000300	Compressor	1	
11	92008-000206	4-way Valve	1	
12	92007-000984	4-way Valve Assembly	1	
13	41202-000229	base	1	
14	41205-000064	Right plate	1	
15	92008-000047	Two-way valve	1	
16	41204-000011	Valve supporter	1	
17	92008-000119	Three-way valve	1	
18	41201-000043	Electrical box cover	1	
19	42001-000036	Cable clamp	1	
	42001-000038	Cable clamp	1	



Exploded View MGTC3623C-17

No.	Part No.	Part Name	Qty	Remark
20	11304-100045	Terminal	1	
21	31201-000981	Outdoor PCB assembly	1	
22	22011-000004	Inductor	1	
23	92007-002096	Capillary Assembly	1	
24	41208-000176	Partition plate	1	
25	10104-100039	Pipe Temp. sensor and outdoor Temp. sensor	1	Not shown in Explosion view
26	10104-100037	Discharge Temp. sensor	1	
28	41204-000047	Valve cover	1	
29	A2005-000509	Base carton	1	
30	A1201-007893	Cabinet carton	1	
31	A1202-000022	Base foaming	1	
32	41213-000017	Cover foaming	1	